

Surface Engineered Down-the-Hole Hammers

This is a radically new Australian design, conceived by an Australian company and manufactured in Australia. LaserBond DTH Hammers dramatically increase the working life and overcome the short life cycles suffered by existing DTH hammers.



LBH-100 (4") Series A DTH Hammer

Technical Data

- Product Name: LaserBond DTH Hammer
- Model Number:..... LBH-100 Series A
- CertificationISO9001
- Casing Diameter 98mm + rib
- Minimum Bit Size 110mm
- Hammer Length 985mm
- Hammer Weight..... 38 Kg
- Working Pressure 10- 25 bar
- Impact Frequency 30Hz@ 17 bar
- Rotation Speed25 - 40 rpm
- Air Consumption 100 - 230 l/s
- Bit Size 110 - 135mm
- Thread Standard API (2 3/8)* Reg

Surface Engineered Down-the-Hole Hammer

LBH-100 (4") Series A - Assembly and Parts Diagram - Parts List

LaserBond DTH Hammers are designed with minimum moving parts specifically for mid-high pressure, high frequency operation. Use part numbers when ordering; go to www.laserbond.com.au

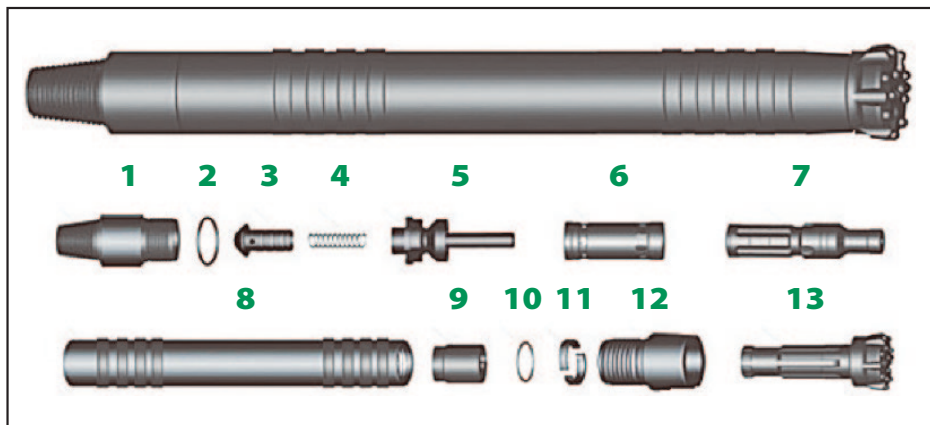

Item	Description	LBH-100 (4")
1	Backhead*	LBH100-BH01
2	Top O-Ring	LBH100-TO01
3	Check Valve	LBH100-CV01
4	Spring	LBH100-SP01
5	Air Distributor	LBH100-AD01
6	Inner Cylinder	LBH100-IC01
7	Piston	LBH100-PS01
8	Hammer Casing	LBH100-HC01
9	Alignment Sieve	LBH100-TO01
10	Bottom O-Ring	LBH100-BO02
11	Bit Retainer Ring	LBH100-BR01
12	Drive Chuck (see below)	LBH100-DC01...

Drill Drive Bit Spline

LaserBond Drill Bits are available in a limited range of common drive splines. Manufactured with added durability to suit the extended operational life of the DTH LaserBond DTH Hammer casing and chuck components. Include Drive Spline designations as /...

Size	Drill Bit Part Number	Matched Bit Diameter	DHD Drive Spline	TD Drive Spline
13	LBB115-DB01/...	110-135mm	.../DHD340	.../TD40

*other backhead thread connections available on request

Surface Engineered Down-the-Hole Hammers

This is a radically new Australian design, conceived by an Australian company and manufactured in Australia. LaserBond DTH Hammers dramatically increase the working life and overcome the short life cycles suffered by existing DTH hammers.



LBH-125 (5") Series A DTH Hammer

Technical Data

Product Name: LaserBond DTH Hammer
Model Number:..... LBH-125 Series A
CertificationISO9001
Casing Diameter 126mm + rib
Minimum Bit Size 135mm
Hammer Length1,105mm
Hammer Weight..... 72 Kg
Working Pressure 10- 25 bar
Impact Frequency 28Hz@ 17 bar
Rotation Speed25 - 35 rpm
Air Consumption 115 - 320 l/s
Bit Size 135 - 155mm
Thread Standard API (2 3/8)* Reg

Surface Engineered Down-the-Hole Hammer

LBH-125 (5") Series A - Assembly and Parts Diagram - Parts List

LaserBond DTH Hammers are designed with minimum moving parts specifically for mid-high pressure, high frequency operation. Use part numbers when ordering; go to www.laserbond.com.au

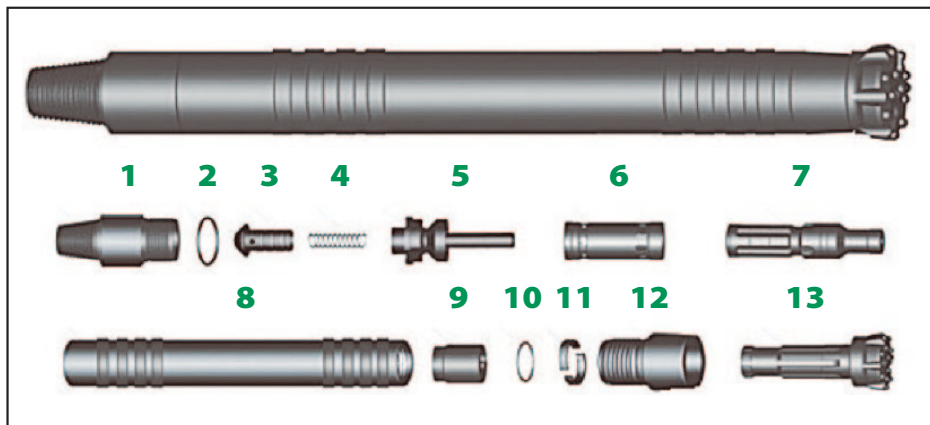

Item	Description	LBH-125 (5")
1	Backhead*	LBH125-BH01
2	Top O-Ring	LBH125-TO01
3	Check Valve	LBH125-CV01
4	Spring	LBH125-SP01
5	Air Distributor	LBH125-AD01
6	Inner Cylinder	LBH125-IC01
7	Piston	LBH125-PS01
8	Hammer Casing	LBH125-HC01
9	Alignment Sieve	LBH125-TO01
10	Bottom O-Ring	LBH125-BO02
11	Bit Retainer Ring	LBH125-BR01
12	Drive Chuck (see below)	LBH125-DC01...

Drill Drive Bit Spline

LaserBond Drill Bits are available in a limited range of common drive splines. Manufactured with added durability to suit the extended operational life of the DTH LaserBond DTH Hammer casing and chuck components. Include Drive Spline designations as /...

Size	Drill Bit Part Number	Matched Bit Diameter	DHD Drive 8 Spline	QL Drive 12 Spline
130	LBB130-DB01/...	125-145mm	.../DHD350	.../QL50
140	LBB140-DB01/...	135-155mm	.../DHD350	.../QL50

*other backhead thread connections available on request

Surface Engineered Down-the-Hole Hammers

This is a radically new Australian design, conceived by an Australian company and manufactured in Australia. LaserBond DTH Hammers dramatically increase the working life and overcome the short life cycles suffered by existing DTH hammers.



LBH-150 (6") Series A DTH Hammer

Technical Data

- Product Name: LaserBond DTH Hammer
- Model Number:..... LBH-150 Series A
- CertificationISO9001
- Casing Diameter 143mm + rib
- Minimum Bit Size 152mm
- Hammer Length1,238mm
- Hammer Weight..... 94 Kg
- Working Pressure 10- 25 bar
- Impact Frequency 25Hz@ 17 bar
- Rotation Speed20 - 30 rpm
- Air Consumption 150 - 430 l/s
- Bit Size 152 - 203mm
- Thread Standard API (3 1/2)* Reg

Surface Engineered Down-the-Hole Hammer

LBH-150 (6") Series A - Assembly and Parts Diagram - Parts List

LaserBond DTH Hammers are designed with minimum moving parts specifically for mid-high pressure, high frequency operation. Use part numbers when ordering; go to www.laserbond.com.au

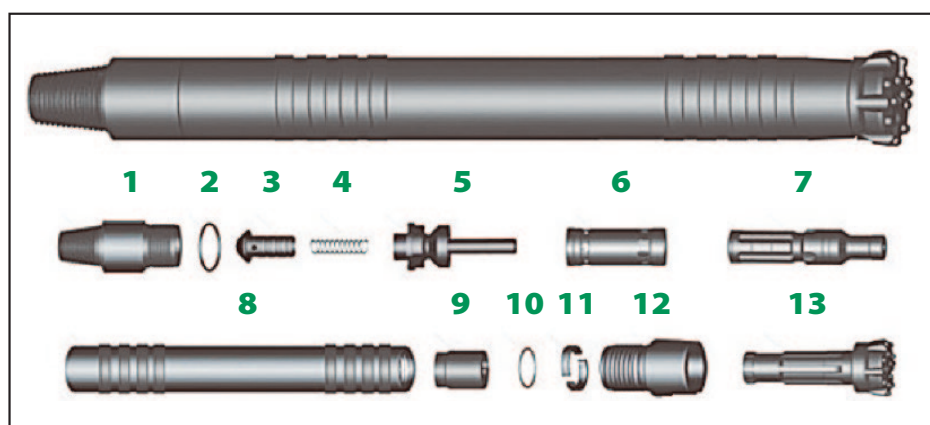

Item	Description	LBH-150 (5")
1	Backhead*	LBH150-BH01
2	Top O-Ring	LBH150-TO01
3	Check Valve	LBH150-CV01
4	Spring	LBH150-SP01
5	Air Distributor	LBH150-AD01
6	Inner Cylinder	LBH150-IC01
7	Piston	LBH150-PS01
8	Hammer Casing	LBH150-HC01
9	Alignment Sieve	LBH150-TO01
10	Bottom O-Ring	LBH150-BO02
11	Bit Retainer Ring	LBH150-BR01
12	Drive Chuck (see below)	LBH150-DC01...

Drill Drive Bit Spline

LaserBond Drill Bits are available in a limited range of common drive splines. Manufactured with added durability to suit the extended operational life of the DTH LaserBond DTH Hammer casing and chuck components. Include Drive Spline designations as /...

Size	Drill Bit Part Number	Matched Bit Diameter	DHD Drive 8 Spline	QL Drive 12 Spline
13	LBB165-DB01/...	152-203mm	.../DHD360	.../QL60

*other backhead thread connections available on request